



Park Board  
Agenda  
Monday, May 18, 2020, 7:00 p.m.  
Kirkwood Community Center  
111 S. Geyer Road  
Kirkwood, MO 63122



**SPECIAL ANNOUNCEMENT REGARDING PARK BOARD MEETINGS**

Under Section 610.015 of the Mo. Sunshine Law provides that members of the Park Board who are not physically at the meeting site can participate and vote on all matters when an emergency exists and the nature of the emergency is stated in the minutes.

The U.S., and the world, is in a state of emergency due to the Coronavirus—Covid-19. The Missouri Governor and the County Executive directed all citizens to limit meetings and gatherings to a few people to avoid the spread of the Coronavirus. Therefore, members of the Park Board have elected to participate in this meeting electronically so that we are compliance with such Orders and for the public health and safety of each other and the general public.

To follow along with the Park Board meeting please see instructions below. To make a comment during the public comment portion of the meeting please click the hand icon to “raise” your hand. Raised hands will be called on the order received. As an alternative, you can submit written comments to Director of Parks and Recreation Kyle Henke at [henkekk@kirkwoodmo.org](mailto:henkekk@kirkwoodmo.org). Comments received by 4:00 p.m. on Monday, May 18, 2020 will be read during the citizen comment portion of the meeting.

You are invited to a Zoom meeting:

When: May 18, 2020 07:00 PM Central Time (US and Canada)

Topic: Kirkwood Park Board Meeting May 18, 2020 at 7 p.m.

Please click the link below to join the meeting:

<https://zoom.us/j/98491601239>

Or Telephone:

Dial 312 626 6799

Webinar ID: 984 9160 1239

**\*\*SEE THE FOLLOWING PAGES FOR THE AGENDA**



**I. CITIZEN COMMENTS** *(See instructions on the previous page for offering a comment. The public comment portion of the meeting is an opportunity to hear comments from citizens. It is not a question and answer session and the Park Board will not respond to comments or answer questions during the comment period. The Chairperson may refer any matter to staff or hold discussion during the "Other Matters" section of the meeting).*

**II. APPROVAL OF MARCH 16, 2020 MEETING MINUTES, FEBRUARY 24, 2020 CLOSED SESSION MINUTES AND MARCH 9, 2020 CLOSED SESSION MINUTES**

**III. COMMITTEE REPORTS**

- a. Partnership Committee

**IV. UNFINISHED BUSINESS**

- a. Interstate 44 Meramec Bridge Update
- b. Strategic Planning Update

**V. NEW BUSINESS**

- a. Election of Officers
- b. Grant's Trail Sign Update
- c. Other Matters

**VI. SUPERINTENDENT OF PARKS REPORT**

**VII. DIRECTOR'S REPORT**

**VIII. BOARD MEMBER COMMENTS**

**IX. ADJOURNMENT**

**Staff Liaison:** Kyle Henke. Phone: 314.822.5856 Email: [henkekk@kirkwoodmo.org](mailto:henkekk@kirkwoodmo.org)

**Chair:** Steve Coates

**Accommodation:** The City of Kirkwood is interested in effective communication for all persons. Persons requiring an accommodation to attend and participate in the meeting should contact the City Clerk at 314-822-5802 at least 48 hours before the meeting. With advance notice of seven calendar days, the City of Kirkwood will provide interpreter services at public meetings for languages other than English and for the hearing impaired. Upon request, the minutes from this meeting can be made available in an alternate format, such as a CD, by calling 314-822-5802.

*From the desk of:*  
Kyle Henke, Director of Parks and Recreation  
111 S. Geyer Road, Kirkwood, MO 63122  
Phone: 314-822-5856 Fax: 314-984-5931  
E-mail: henkekk@kirkwoodmo.org



## Memo

To: Kirkwood Park Board  
From: Kyle Henke  
Date: May 12, 2020  
Re: May 18, 2020 Agenda Memo

---

Here are the topics to be covered at this meeting which will be held in "Zoom" virtual format:

### **Committee Reports**

Partnership Committee – Due to the COVID-19 outbreak nothing has been accomplished regarding the proposals previously considered by the Board. Staff has not received any communications from any of the applicants at this point.

### **Unfinished Business**

I-44 Meramec River Pedestrian Bridge – The initial conceptual plans for the bridge touchdowns and trailhead amenities are through their first draft. Important excerpts from those plans are included in the packet. There are some minor changes to the plans expected as we work through the review process with MoDOT. Most of these changes involve MoDOT's access on both sides of the river for maintenance purposes. Key elements of the conceptual plan are as follows:

- The idea of making improvements to Stoneywood Drive to improve connectivity between the pedestrian bridge and Powder Valley has been abandoned due to cost.
- The Board's request that the parking lot on the east side be expanded to 20 parking spots is being honored.
- The overlook tower is still part of the plan at this time. It will be bid as an add alternate as there are still concerns about the cost for the project and the tower would probably be the first thing to go.

Strategic Planning Update – this represents the monthly opportunity to provide updates on any actions taken relative to the strategic plan.

## **New Business**

Park Board Officer Elections—Results of the election for Park Board officers conducted via email will be announced.

Grant's Trail Sign Update – Great Rivers Greenway District is planning on updating the signs along Grant's Trail. There are four signs at the Kirkwood trailhead that would be replaced as part of this program. The packet includes information on these changes

Maintenance Report – Curt's report is included as is the report from Ron Hall.

Director's Report – My report will include information on the following:

- Update on the Performing Arts Center project
- Possible protection for the Emmenegger Park river bank



**Park Board  
Meeting Minutes  
Monday, March 16, 2020, 7:00 p.m.  
Kirkwood Community Center, East Gym  
111 S. Geyer Road  
Kirkwood, MO 63122**



**IN ATTENDANCE:** The meeting was called order at 7:01 p.m. with President Steve Coates, Alan Hopefl, Kathy Paulsen, Dave Hufford, Alvin Reid, Scott Stream, Jordan Wienke, Lara Goeke and Staff Liaison Murray Pounds, Curt Carron and Kyle Henke in attendance.

**I. CITIZEN COMMENTS**

None

**II. APPROVAL OF FEBRUARY 24, 2020 MEETING MINUTES**

A motion made by Dave Hufford, seconded by Scott Stream.

Aye: Alan Hopefl, Jordan Wienke, Alvin Reid, Scott Stream, Kathy Paulsen

Abstain: Dave Hufford

Motion approved.

**III. COMMITTEE REPORTS**

- a. Partnership Committee – Two of the petitions for memorials have not responded to requests for more information. The other is awaiting research by the Historical Society.

**IV. UNFINISHED BUSINESS**

- a. I-44 Meramec River Pedestrian Bridge update – No updates available at this time.
- b. Strategic Plan- Kirkwood Parks Foundation meeting rescheduled for 6pm April 20<sup>th</sup>.
- c. Park Board Officer Nominations – Steve Coates briefed The Board on the candidates for the positions.

**V. NEW BUSINESS**

- a. Fiscal Year 2020-21 Park Fund Budget – A motion made by Scott Stream to approve the Park Fund budget as presented with total operating and capital costs of \$1,756,112 and revenues of \$1,757,430, seconded by Dave Hufford. Motion approved unanimously.
- b. Capital Re-appropriations – A motion made by Alan Hopefl to approve re-appropriation of funding from FY 2019-20 to FY 2020-21 of \$50,000 from Account #201-5101-452-7504 PF2003 and \$1186 from Account #201-5101-452-7504 PF1911, seconded by Kathy Paulsen. Motion approved unanimously.
- c. 2020 Mowing Contract – A motion made by Kathy Paulsen to approve the contract with MK Landscaping for the 2020 mowing season in the amount of \$27,678, seconded by Alvin Reid. Motion approved unanimously.

**VI. SUPERINTENDENT OF PARKS REPORT**

- a. Curt Carron discussed Superintendent of Parks' report.



## **VII. DIRECTORS REPORT**

- a. Performing Arts Center – Construction is moving forward rapidly.
- b. Property Tax Revenue – Property tax revenue is higher than the previous year.
- c. Fence at Quarry Park – Murray brought a fencing issue to the board that may need to be addressed in the coming year.
- d. Sculpture on the Move – New Sculptures are being placed soon.
- e. Great Rivers Greenway – They are developing new signs that will be placed at the trailhead a Greentree Park.
- f. COVID – 19 – Murray discussed the efforts that are being made by the Parks and Recreation team to protect customers and staff.

## **VIII. BOARD COMMENTS**

- a. Dave Hufford asked how the next meeting may work if the Community Center is closed. Murray is looking into the available options and will let the board know if there are any changes for the next meeting.

**IX. ADJOURNMENT** – Chair Steve Coates adjourned the meeting at 7:38 p.m.

# I-44/MERAMEC RIVER CROSSING - TRAIL BRIDGE APPROACHES

CITY OF SUNSET HILLS, MISSOURI  
TOWNSHIP 44 NORTH, RANGE 5 EAST, SECTION 14

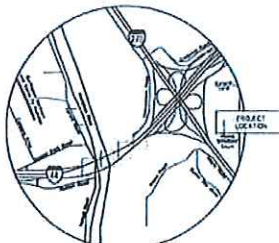

VICINITY MAP  
NOT TO SCALE

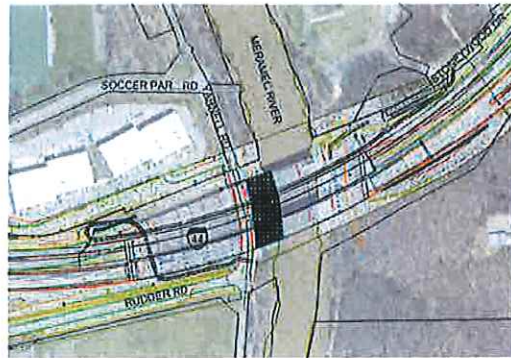

**PROJECT TEAM**

<b>OWNER:</b>	<b>CITY OF SUNSET HILLS</b> 2018 S. Lindbergh Boulevard Sunset Hills, MO 63127 (314) 563-3000
	<b>CITY OF J.R. WOOD</b> 100 East. Grand Street Joplin, MO 64501 (417) 623-3000
	<b>CITY OF FENTON</b> 425 West 3rd Street Fenton, MO 63425 (314) 343-3200
<b>CIVIL ENGINEER:</b>	<b>INTUITION &amp; LOGIC</b> 4111 S. Brentwood St. Louis, MO 63111 (314) 733-1000
<b>STRUCTURAL ENGINEER:</b>	<b>EFK Moen, LLC</b> 2111 Riverchase St. Louis, MO 63114 (314) 993-1000
<b>LANDSCAPE ARCHITECT:</b>	<b>SWT DESIGN</b> 7122 S. Brentwood St. Louis, MO 63111 (314) 350-1000
<b>GEOTECHNICAL ENGINEER:</b>	<b>GEOTECHNOLOGY INC</b> 110 E. Lombard Road St. Louis, MO 63110 (314) 361-1000
<b>SURVEYOR:</b>	<b>SABUR, INC</b> 1711 Springfield St. Louis, MO 63114 (314) 350-1000

**INDEX**

SHEET NO.	DESCRIPTION
1	COVER
2	NOTES, LEGEND AND ABBREVIATIONS
3	PLAN AND PROFILE
4	PIPE PROFILE AND SECTIONS
5-7	DETAILS

<p>THE PROFESSIONAL ENGINEER'S SIGNATURE AND PERSONAL SEAL APPEARING ON THIS RESPONSIBILITY CERTIFICATION APPLIES TO THE WORK AND DESIGN PRESENTED TO SECTION 27.111 AS SOLELY RESPONSIBLE FOR ALL TECHNICAL SPECIFICATIONS, ESTIMATES, REPORTS OR OTHER DOCUMENTS OR DELIVERABLES PREPARED BY THE UNDERSIGNED PROFESSIONAL ENGINEER OR WORKING UNDER HIS OR HER SUPERVISION OF THIS PROJECT TO WHICH THIS PAGE REFERS.</p>	<p>Professional Engineer Seal Mary Ann O'Neil, Engineer No. 12000-0118</p> <p><b>PRELIMINARY NOT FOR CONSTRUCTION</b></p> <p>Expirates Date: Dec 31, 2018</p>
---	---





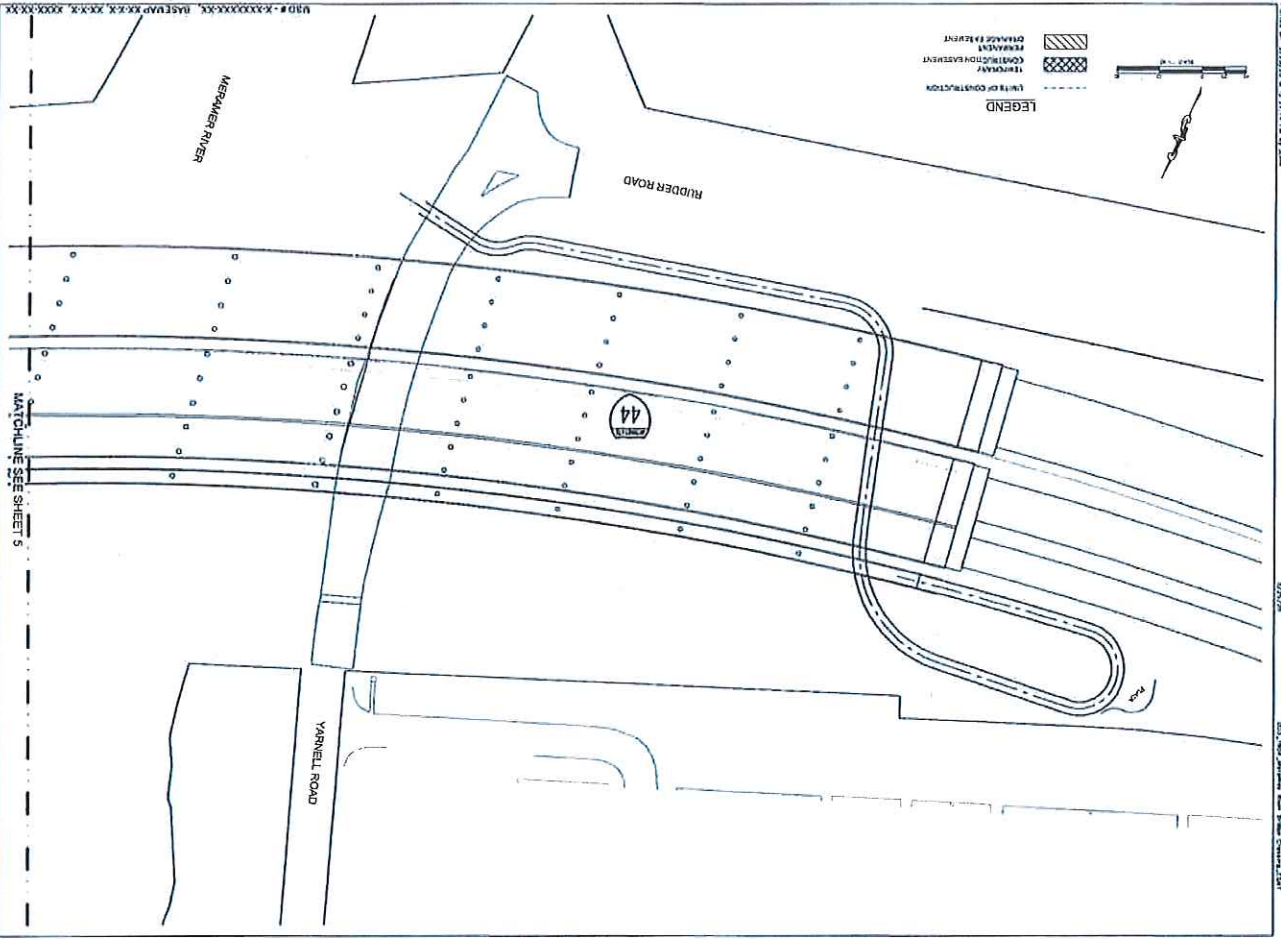

1 OF 11

DATE: 1/27/08	PROJECT NO: 104
DESIGNER: EMBRY & MCELREATH	SCALE: AS SHOWN
CHECKED: [Signature]	DATE: 1/27/08
APPROVED: [Signature]	DATE: 1/27/08

**PROFESSIONAL ENGINEER**  
MICHIGAN REG. NO. 10423

**1-44/MERAMEC RIVER CROSSING - TRAIL BRIDGE APPROACHES**  
City of Soudan Hills, Missouri

INTUITIION  
1000 N. GARDEN ST.  
ANN ARBOR, MI 48106  
TEL: 734.769.1000  
WWW.INTUITIION.COM

**INTUITIION**  
ENGINEERS ARCHITECTS



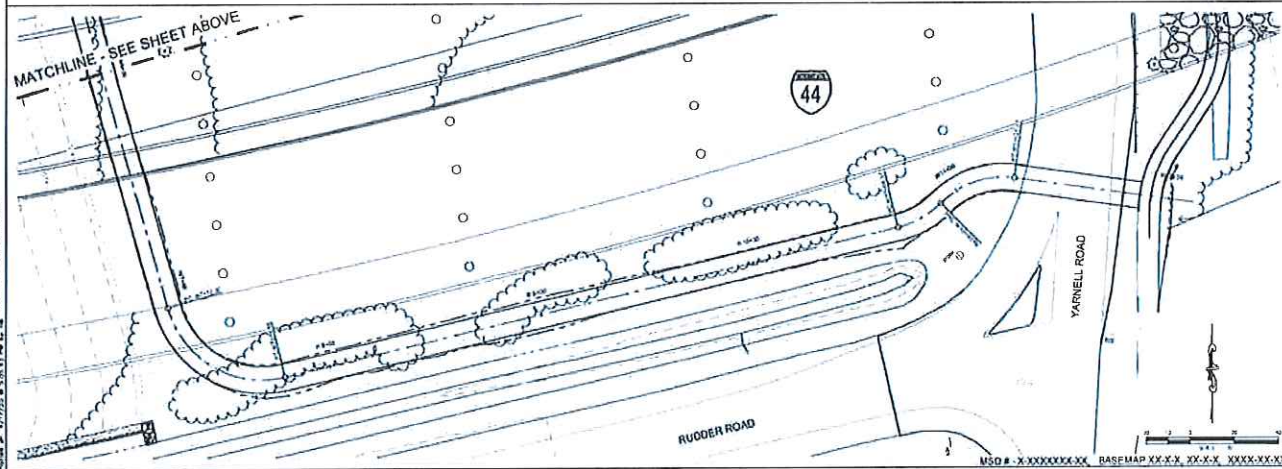
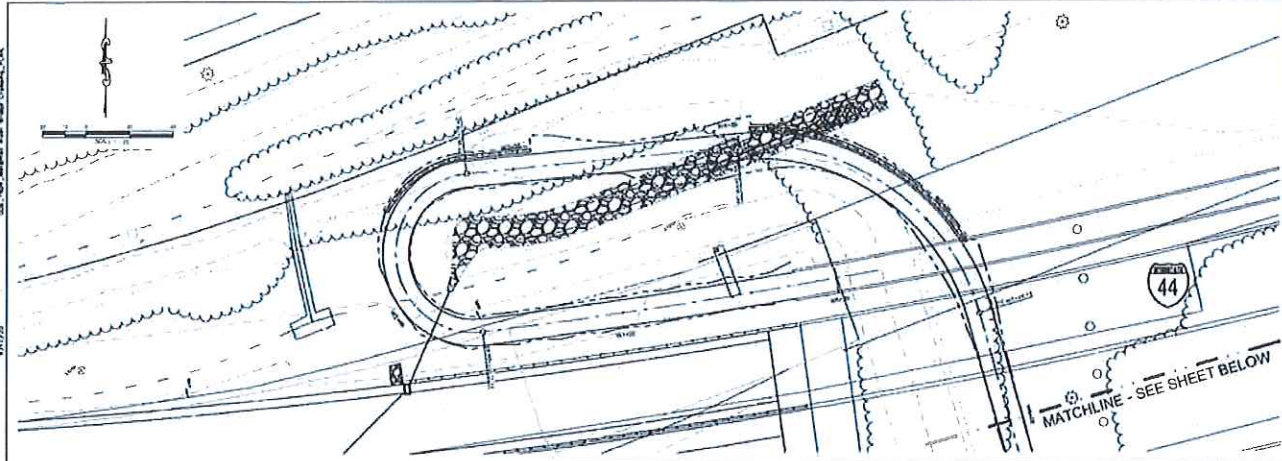

City of  
**Yarnell Hills**



**INTUITION**  
LLC  
Civil Engineer  
Professional Engineer No. 1000000000  
State of Oregon  
1000 NE Oregon Street  
Portland, Oregon 97232  
503.255.1111  
www.intuitionllc.com

**I-44/MEADOW RIVER  
CROSSING - TRAIL BRIDGE  
APPROACHES**  
City of Yarnell Hills, Oregon

Professional Engineer and  
Printing Plans Exam. Expires  
10/1/2025  
**PRELIMINARY  
NOT FOR  
CONSTRUCTION**  
Revision Date: 05/11/2024

NO.	DATE	DESCRIPTION
1	05/11/2024	ISSUED FOR PERMITS
2	05/11/2024	ISSUED FOR PERMITS
3	05/11/2024	ISSUED FOR PERMITS
4	05/11/2024	ISSUED FOR PERMITS
5	05/11/2024	ISSUED FOR PERMITS
6	05/11/2024	ISSUED FOR PERMITS
7	05/11/2024	ISSUED FOR PERMITS
8	05/11/2024	ISSUED FOR PERMITS
9	05/11/2024	ISSUED FOR PERMITS
10	05/11/2024	ISSUED FOR PERMITS

PROJECT NO: 1924  
PLAN: W&S CONNECTION  
SHEET NO: 8 OF 33



**I-44 / Meramec River Bridge Crossing - Trail Bridge Approaches**

Submittal Type: Preliminary  
Date:

**ENGINEERS OPINION OF CONSTRUCTION COST**

Description	Unit	Quantity	Unit Cost	Sub Total	Percent
Mobilization	LS	1	\$ 35,000.00	\$ 35,000.00	4.71%
Tree Protection, Erosion and Sediment Control	LS	1	\$ 14,000.00	\$ 14,000.00	1.88%
Clearing (Tree Removal)	LS	1	\$ 2,000.00	\$ 2,000.00	0.27%
Excavation Class "A"	CY	259	\$ 15.00	\$ 3,885.00	0.52%
Compacted Soil Backfill	CY	779	\$ 36.00	\$ 28,044.00	3.78%
Asphalt Pavement - 4" thick	SY	3,763	\$ 40.00	\$ 150,520.00	20.26%
Concrete Pavement - 5" thick, reinforced	SY	455	\$ 50.00	\$ 22,750.00	3.06%
Gravel Trail - 6" thick	SY	80	\$ 72.00	\$ 5,760.00	0.78%
Type 5 Aggregate Base	CY	787	\$ 72.00	\$ 56,664.00	7.63%
Curb and Gutter	LF	463	\$ 34.00	\$ 15,742.00	2.12%
Modular Block Wall	SF	2,005	\$ 56.00	\$ 112,280.00	15.11%
Rock Lined Swale	CY	41	\$ 60.00	\$ 2,460.00	0.33%
30" Storm Pipe - RCP Class III	LF	58	\$ 85.00	\$ 4,930.00	0.66%
Toe Wall	LF	10	\$ 100.00	\$ 1,000.00	0.13%
30" Flared End Section (RCP)	EA	2	\$ 1,750.00	\$ 3,500.00	0.47%

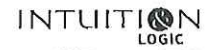

**I-44 / Meramec River Bridge Crossing - Trail Bridge Approaches**

Submittal Type: Preliminary  
Date:

**ENGINEERS OPINION OF CONSTRUCTION COST**

Pavement Striping	LF	2,186	\$ 2.00	\$ 4,372.00	0.59%
72" Chainlink Fence	LF	240	\$ 55.00	\$ 13,200.00	1.78%
Turf Seeding	SY	3,147	\$ 2.50	\$ 7,867.50	1.06%
Wayfinding	EA	3	\$ 5,000.00	\$ 15,000.00	2.02%
Entrance Monument	EA	1	\$ 8,000.00	\$ 8,000.00	1.08%
Interpretive Signage Allowance	LS	1	\$ 6,000.00	\$ 6,000.00	0.81%
Overlook Structure (East)	LS	1	\$ 37,000.00	\$ 37,000.00	4.98%
Small Pavilion (West)	LS	1	\$ 14,000.00	\$ 14,000.00	1.88%
Small Shade Structure and Table (East)	EA	3	\$ 12,000.00	\$ 36,000.00	4.85%
Blke Rack	EA	8	\$ 1,400.00	\$ 11,200.00	1.51%
Blke Repair Station	EA	2	\$ 2,800.00	\$ 5,600.00	0.75%
Waste Receptable	EA	3	\$ 1,400.00	\$ 4,200.00	0.57%
Drinking Fountain	EA	2	\$ 14,000.00	\$ 28,000.00	3.77%
Rain Garden	SF	1,965	\$ 25.00	\$ 49,125.00	6.61%
Planting Bed	SF	3,844	\$ 7.00	\$ 26,908.00	3.62%
Trees	SF	42	\$ 425.00	\$ 17,850.00	2.40%





**I-44 / Meramec River Bridge Crossing - Trail Bridge Approaches**

Submittal Type: Preliminary  
Date:

**ENGINEERS OPINION OF CONSTRUCTION COST**

Modular Block Wall	SF	3,597	\$ 56.00	\$ 201,432.00	27.12%
Rock Lined Swale	CY	8	\$ 60.00	\$ 480.00	0.06%
Pavement Striping	LF	1,252	\$ 2.00	\$ 2,504.00	0.34%
72" Chainlink Fence Remove and Relocate	LF	2,557	\$ 55.00	\$ 140,835.00	18.93%
Turf Seeding	SY	888	\$ 2.50	\$ 2,220.00	0.30%
Subtotal Cost Opinion = \$				639,707	#DIV/0!
15% Contingency = \$				95,956	
<b>TOTAL = \$</b>				<b>736,000</b>	
<b>TOTAL WITH BID ALTS = \$</b>				<b>1,591,000</b>	







DATE	11/11/11
PROJECT NO.	108
SCALE	AS SHOWN
DESIGNED BY	
CHECKED BY	
APPROVED BY	

**PROFESSIONAL ENGINEER**  
 STATE OF MISSISSIPPI  
 No. 10828  
 JOHN W. HARRIS, P.E.

**LAURENCE RIVER  
 CROSSING - TRAIL BRIDGE  
 APPROACHES**  
 City of Ocean Springs, Alabama

LAURENCE RIVER  
 CROSSING - TRAIL BRIDGE  
 APPROACHES

INTENTION  
 OF THIS DRAWING IS TO  
 SHOW THE LOCATION OF THE  
 BRIDGE AND APPROACHES  
 ONLY. THE BRIDGE AND  
 APPROACHES SHALL BE  
 CONSTRUCTED IN ACCORDANCE  
 WITH THE STANDARD  
 SPECIFICATIONS FOR  
 HIGHWAY BRIDGES AND  
 APPROACHES, 10TH EDITION,  
 2002, AS AMENDED.

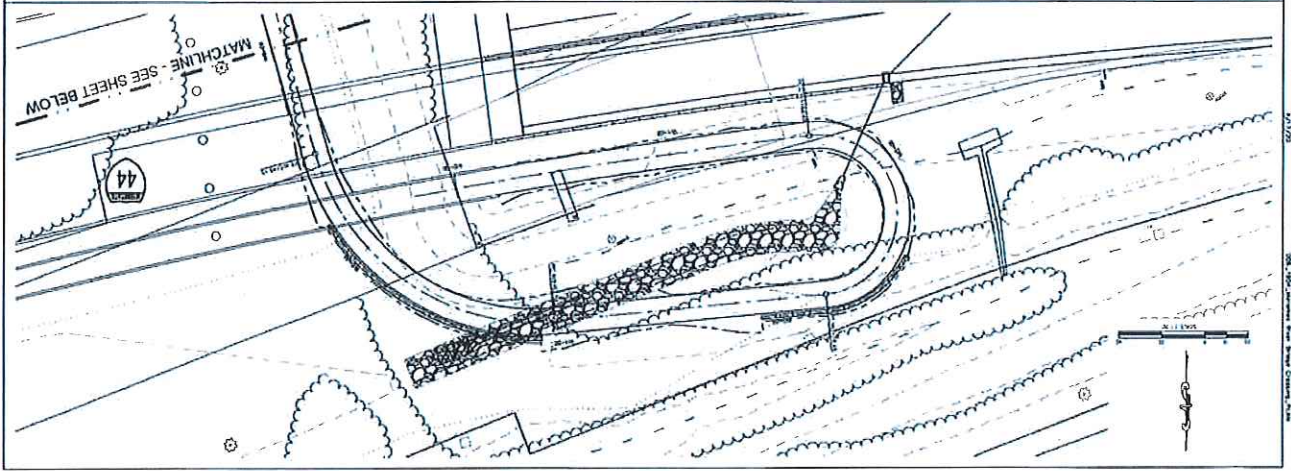
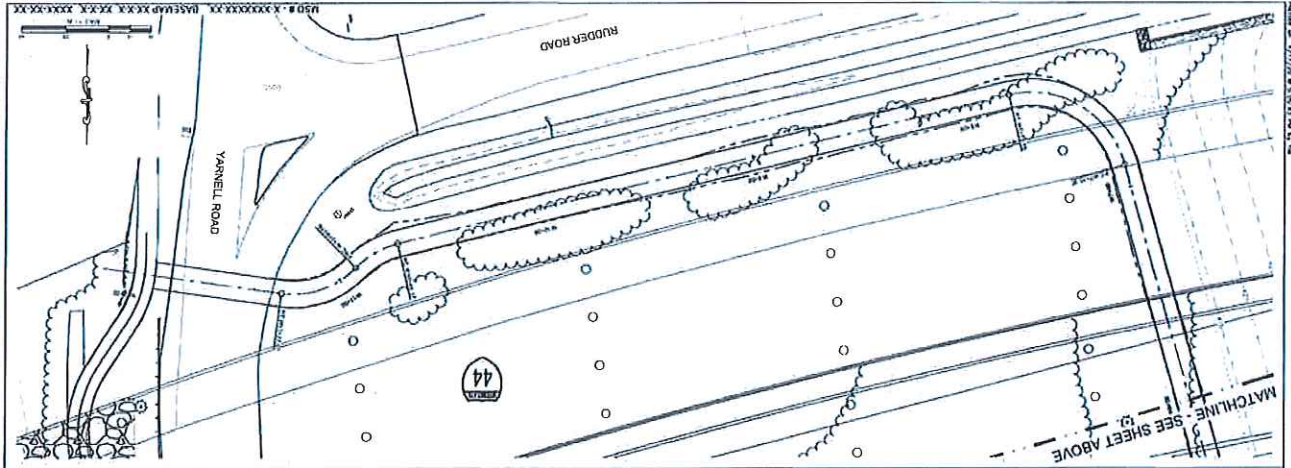

11/11/11  
 JOHN W. HARRIS, P.E.  
 PROJECT NO. 108  
 LAURENCE RIVER CROSSING - TRAIL BRIDGE APPROACHES  
 CITY OF OCEAN SPRINGS, ALABAMA

## I-44 Meramec River Crossing - Trail Bridge Approaches

### SMALL PAVILION (WEST)

This structure is 12 x 12 and would accommodate a picnic table for seating and dining on the plaza at the west bridge approach. The two columns allows more circulation area.



### SMALL SHADE AND TABLE (EAST)

This small structure and built in table is provided in a grouping of 3, located in the plaza west of the parking area on the east approach.



### OVERLOOK (EAST)

This overlook structure would be approximately 4-5 feet above ground at its highest point looking towards the river. We anticipate the support structure to be concrete piers with wood or steel framing, and recycled plastic or metal grate decking.





Great Rivers Greenway

# Gravois Greenway Sign Placement Plan & Environmental Graphics

DD Final Review Set - Municipalities  
5/4/20

---

## Project Goals & Overview

The over arching goal of the new signage and environmental graphics updates is to enhance the overall user experience. This project will bring the entire greenway alignment up to current signage and graphics standards matching the in-progress Gravois Greenway extension from Orlando's to the River Des Peres Greenway.

This will be accomplished by:

- Replacing the existing signage from the Grant's Trail Kirkwood Trailhead to the Mysun Charitable Foundation Trailhead with the current GRG Sign Design Standard of new wayfinding signage, maps and informational kiosks.
- Implementing parts of the GRG Environmental Graphics Toolkit into this section of the greenway to create unique experiences along the trail.

# Sign Type Array: New Design Standard

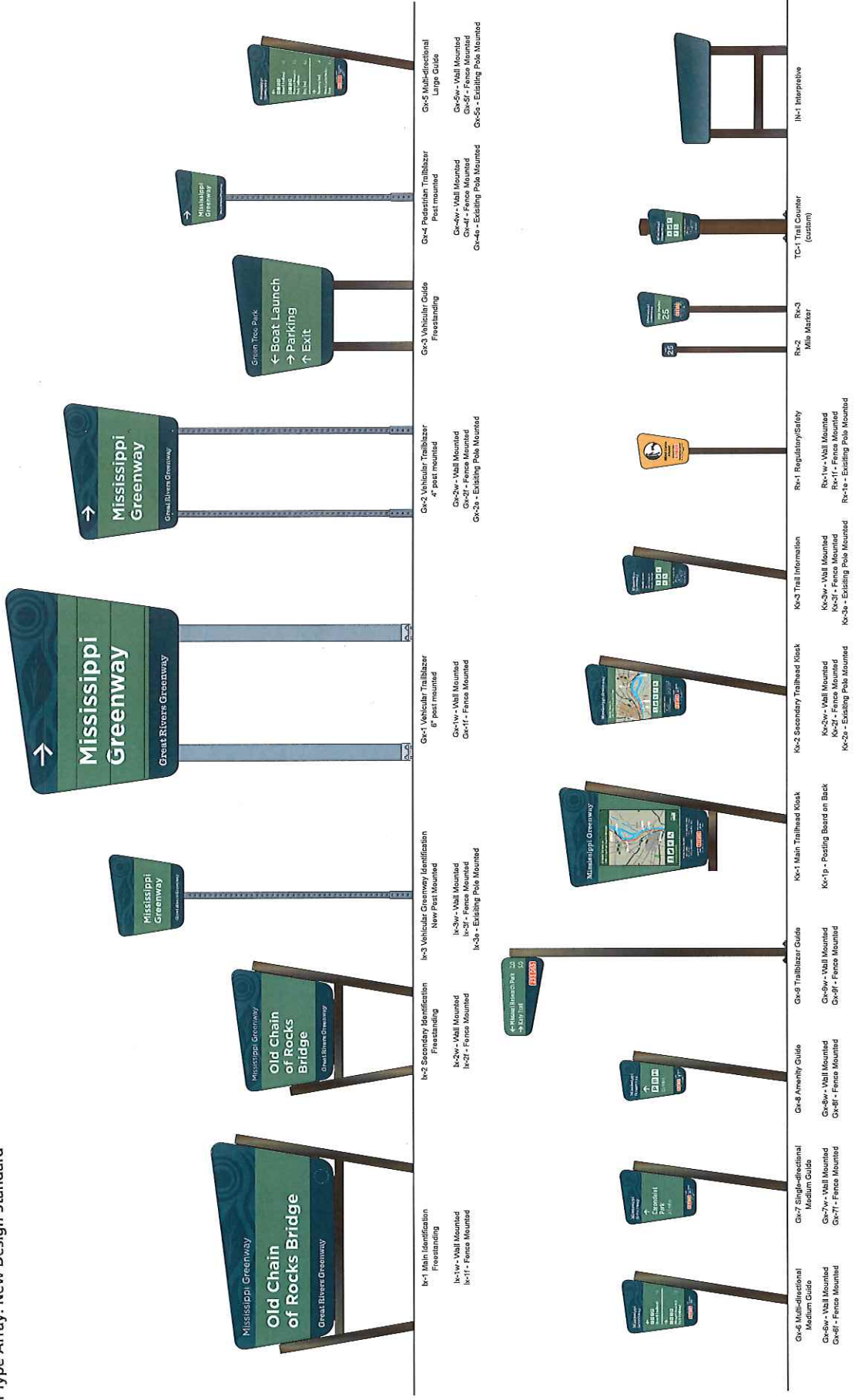

Sign Description	Code	Mounting Options
Ix-1 Main Identification Freestanding	Ix-1	Wall Mounted, Pole Mounted
Ix-2 Secondary Identification Freestanding	Ix-2	Wall Mounted, Pole Mounted
Ix-3 Vehicular Greenway Identification New Post Mounted	Ix-3	Wall Mounted, Pole Mounted, Existing Pole Mounted
Gx-1 Vehicular Trailblazer 8' Post Mounted	Gx-1	Wall Mounted, Pole Mounted, Existing Pole Mounted
Gx-2 Vehicular Trailblazer 4' Post Mounted	Gx-2	Wall Mounted, Pole Mounted, Existing Pole Mounted
Gx-3 Vehicular Guide Freestanding	Gx-3	Wall Mounted, Pole Mounted, Existing Pole Mounted
Gx-4 Pedestrian Trailblazer Post Mounted	Gx-4	Wall Mounted, Pole Mounted, Existing Pole Mounted
Gx-5 Multi-directional Large Guide	Gx-5	Wall Mounted, Pole Mounted, Existing Pole Mounted
Gx-6 Multi-directional Medium Guide	Gx-6	Wall Mounted, Pole Mounted, Existing Pole Mounted
Gx-7 Single-directional Medium Guide	Gx-7	Wall Mounted, Pole Mounted, Existing Pole Mounted
Gx-8 Amenity Guide	Gx-8	Wall Mounted, Pole Mounted, Existing Pole Mounted
Gx-9 Trailblazer Guide	Gx-9	Wall Mounted, Pole Mounted, Existing Pole Mounted
Kx-1 Main Trailhead Kiosk	Kx-1	Posting Board on Back
Kx-2 Secondary Trailhead Kiosk	Kx-2	Wall Mounted, Pole Mounted, Existing Pole Mounted
Kx-3 Trail Information	Kx-3	Wall Mounted, Pole Mounted, Existing Pole Mounted
Rx-1 Regulatory/Safety	Rx-1	Wall Mounted, Pole Mounted, Existing Pole Mounted
Rx-2 Mile Marker	Rx-2	Wall Mounted, Pole Mounted, Existing Pole Mounted
Tx-1 Trail Counter (custom)	Tx-1	Interpretive

# Overall Sign Placement Plan

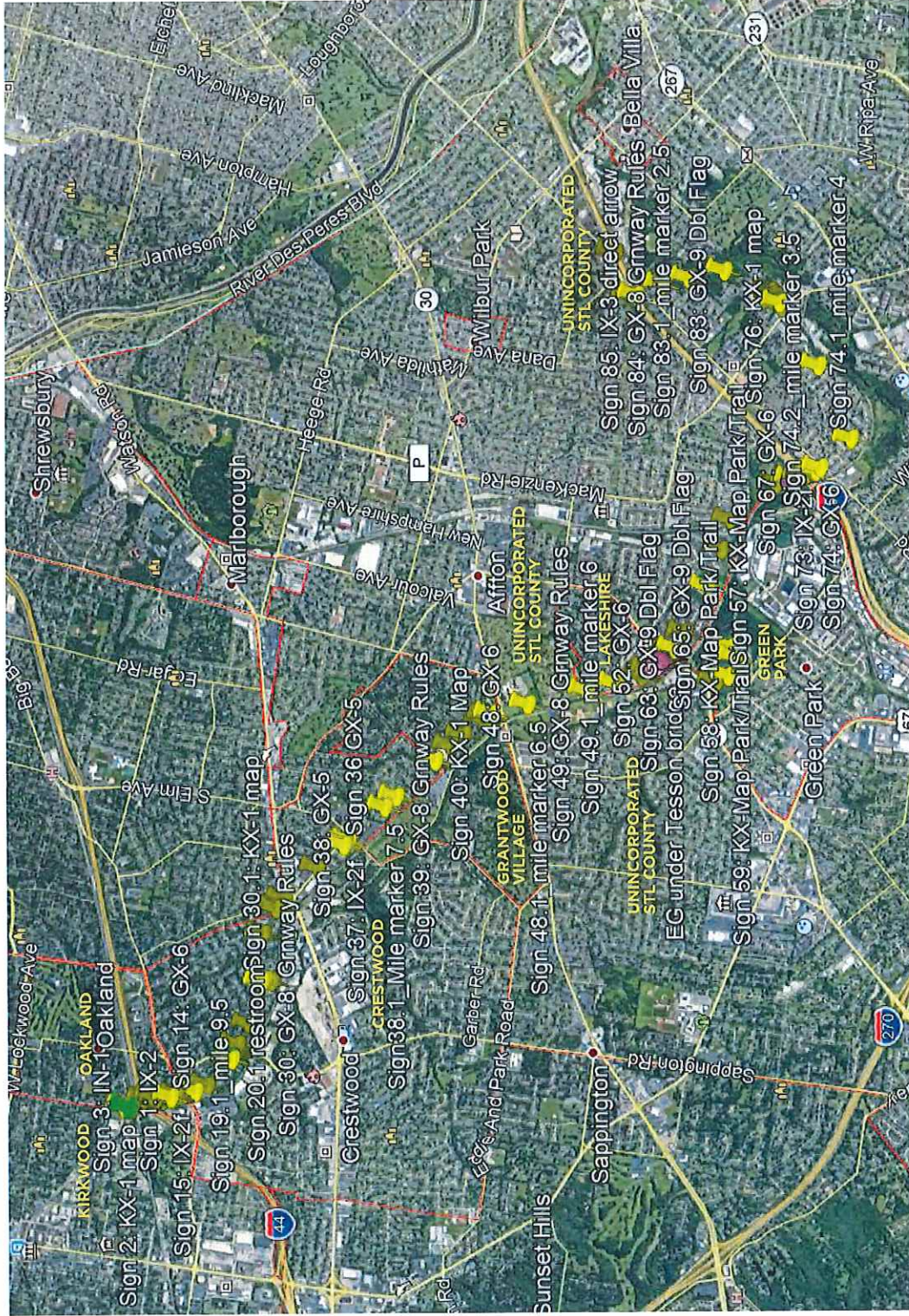

## Project Scope

- Replacement of existing signage and addition of environmental graphics
- Area is from the Grant's Trail Kirkwood Trailhead to the Mysun Charitable Foundation Trailhead
- Proposed overall plan includes 85+ signs  
(will update number & map when final)



**Great Rivers Greenway**

# Kirkwood



# Sign Placement Plan - Kirkwood

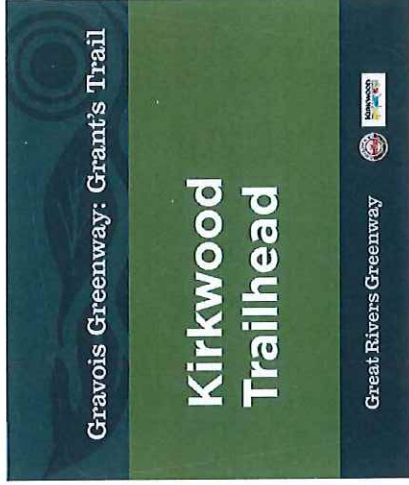

Sign 1 - IX-2  
Front

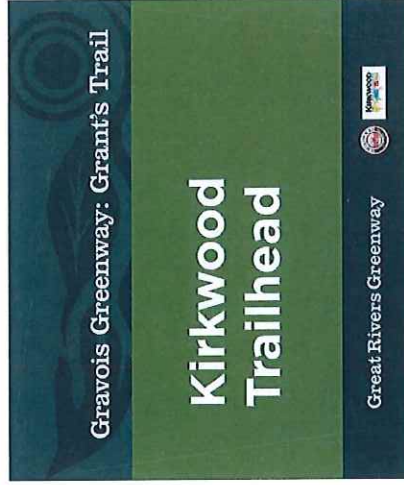

Sign 1 - IX-2  
Back

# Sign Placement Plan - Kirkwood



Existing condition

Kirkwood request for new restroom signs

Sign 1.1 - Set of Men's and Women's Restroom signs

Engraphix to procure new pre-fab ADA-compliant signs, drill hole in each corner, and install with black screws so city can remove and reinstall when restrooms are renovated. 2 quantity of Men's and Women's.

ComplianceSigns.com

4.7 out of 5 based on 4,467 reviews

Excellent

What can we help you find?

Search Q

Create Custom Sign

Black ADA Braille Women - MEN Accessible Restroom Sign Set RRE-130\_150PairedSet\_White\_on\_Black

Select Material

Acrylic

Select Size

STANDARD ADA Acrylic Sign 9x6 in., Two Signs \*  
 Price Each: \$38.00  
 Quantity: 1  
 Total: \$38.00

Compare Sizes

\$38.00

Add to Cart

Who's a Reviewer? | Ask a question

Volume Purchase Pricing

Quantity:	44-49	50-99	100+
Discount:	5%	10%	15%



# Sign Placement Plan - Kirkwood



## Gravois Greenway: Grant's Trail

River Des Peres Greenway  
to Kirkwood Trailhead - 10 mi

[www.GreatRiversGreenway.org](http://www.GreatRiversGreenway.org)  
 Great Rivers Greenway  
 COUNTY OF ST. LOUIS  
 MISSOURI

**Please Share the Path**

- No Motorized Vehicles
- Do Not Block Trail
- Keep Right & Pass on Left
- Obey Traffic Signs
- Yield to Pedestrians
- Keep Pets Leashed & Close

**USNG**  
 Location Code: **155 YC XXX XXX**  
 Report a problem: [1.800.432.7008](http://1.800.432.7008) or [info@grg.net](mailto:info@grg.net)  
 Emergency Call 911

Sign 2 - KX-1  
Front & Back w/map

# Sign Placement Plan - Kirkwood



## A Route Carved by Water, Rail & Trail

### Travel Throughout Time

**Gravols Creek**  
Natural and built features inside the park preserve and define the region. Gravel Creek provided fertile land for the people of the excavation and farmland. The river which meanders through the creek. This fall and made an ideal route for a rail line. Local natural history museum features make your community a good place to visit.

**Train Travel**  
Many agencies, such as the Gravel Greenway, traveled the routes of the rail lines that covered the area. The Gravel Greenway was once the Kirkwood Light Rail. The rail line was built in the 1970s, construction on the rails began in 1970. The trail is now a part of the City of Kirkwood. Local history is a part of the trail. It spans many of the Gravel Greenway's history. The trail is a part of the City of Kirkwood's history. The trail is a part of the City of Kirkwood's history. The trail is a part of the City of Kirkwood's history.

**Rail to Trail**  
Like the history, agencies who traveled the routes of the rail lines that covered the area. The Gravel Greenway was once the Kirkwood Light Rail. The rail line was built in the 1970s, construction on the rails began in 1970. The trail is now a part of the City of Kirkwood. Local history is a part of the trail. It spans many of the Gravel Greenway's history. The trail is a part of the City of Kirkwood's history. The trail is a part of the City of Kirkwood's history.

Sign 3 - IN-1

## Sign Placement Plan - Kirkwood

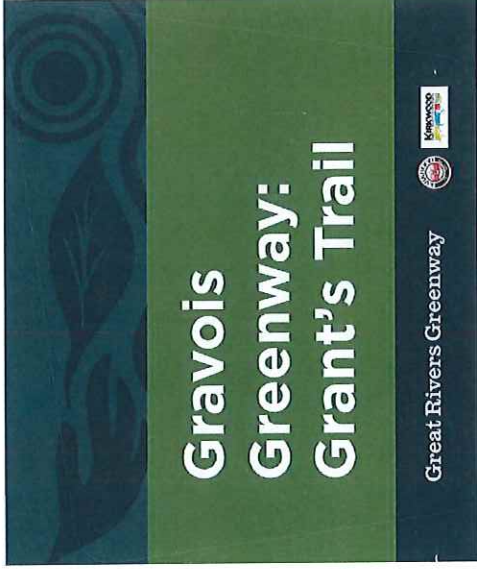

Sign 4 - IX-2f

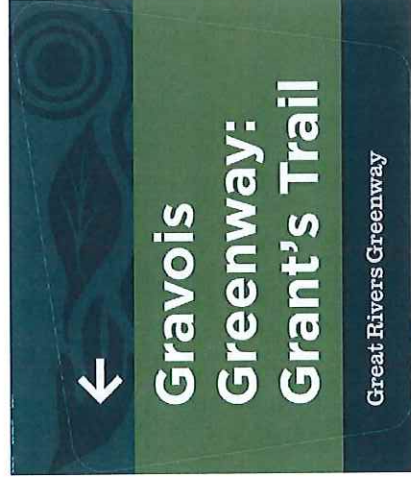

Sign 5 - IX-3

# **MAINTENANCE REPORT FOR APRIL 2020**

## **For Period March 16 through May 12, 2020**

### **COVID19 LOGISTICS:**

Much of April was spent with crew reductions, altering schedules, sanitizing the shop and herding an ever-growing restless public. The scheduling went from a supervisor and 1 crew initially to supervisor and 2 crew, and finally a return to all crew in place with alternate start, lunch, and finish times. That is where we stand now. We have had ample sanitizing supplies to date. No one has reported any kind of an illness. We ordered and received an IFR thermometer which is part of our required check-in protocol in the morning. We also have ordered but not yet received a UV sanitizing lamp. It will be used to sanitize the shop, vehicles, and restrooms on a regular basis. We have instead borrowed one from our safety department in the interim. The public is growing in numbers at all parks, but for the most part all seem to be self-distancing. Playgrounds, pavilions, restrooms and all fields and courts remain closed to organized play. We have allowed the sporadic 2-3 kid whiffle ball or kickball on the infields;. But we've only had one team sneak a practice in somehow on Dia 5/6 a week or so ago. Fields remain closed but are almost ready for play should the softball season resume in June. Picnic tables have not been distributed yet. The tennis court contractor has been working on surfacing courts 1-4, while we have relayed the Sport Court surface on the pickleball court. It was time for us to gear up and ramp up our activity which began on May 4.

### **CAMPBELL PAVILION COMPLETED:**

The finishing touches are almost complete. Grill and trash receptacles are set, the pavilion floor and walks have been cleaned and sealed. Sod has been laid around the concrete edge to help stabilize the perimeter. The rest of the bare ground was seeded and strawed with matting. The drinking fountain will be installed soon and Pete will be planting a limited number of shrubs strategically.

### **MEACHAM SPRAYPAD COMPLETED:**

The spraypad renovation at Memorial Park has been completed. Westport took out all the existing spray heads and installed an actuator, controller, and single water feature in the center of the pad. They completed the work the first week of May, 3 weeks ahead of anticipated start date.

### **PRAIRIE WETLAND SPRING MOW:**

The prairie was mowed at 12" in effort to catch Johnsongrass and Hemlock from reaching seed stage. The Johnsongrass has all but disappeared throughout, while the Hemlock seems to be mostly confined to outside the actual prairie project site, consistent with the mowing prior to seed crowning and dispersal.

### **EMMENEGGER RIVER BANK:**

The river bank continues to scour away bank and toe with each high water stage. Murray, Kyle and I met with the MODOT project team a few weeks ago and are working to get both clean concrete pavement rubble without rebar and the contingency of the causeway rubble as it is removed to armor the river bank. While neither are a sure thing promised to us, there was the willingness to try and accommodate our request. Both methods have been given tentative approval from the Corps (ACE) to be used in our circumstance, however the earliest we might see any material brought in would be possibly fall of 2020, with more material available in fall of 2021. In the meantime, we hold our breath and hope we don't lose and more significant bank soils from flooding. Interestingly, this exact method for armoring is being used directly across the river from our bank, with truckloads of clean concrete rubble being dumped and manipulated to armor the western shoreline.

### **SBD FLOWERS:**

The Horticulture crew has received and is installing spring flowers in the intersection pots, beds and parkway endcaps on Argonne. In effort to hold costs down for later this year, we are not planning at this time to order replacement bulbs for the 2021 spring, instead cutting foliage back and leaving the bulbs for next year which we don't normally do. We will still get flowering bulbs coming back but they won't be as showy as we are used to each spring.

### **CAPITAL EXPENSES:**

We have decided to hold or defer all capital equipment or projects except to finish the Meacham spray fountain. Due to the decrease in revenue across the board, we will continue to operate equipment another year, and make repairs or patchwork other capital items such as playground surfacing issues or irrigation design and install for ballfields.

# Monthly Volunteer Activity Report



March | 2020

## March Volunteer Hours

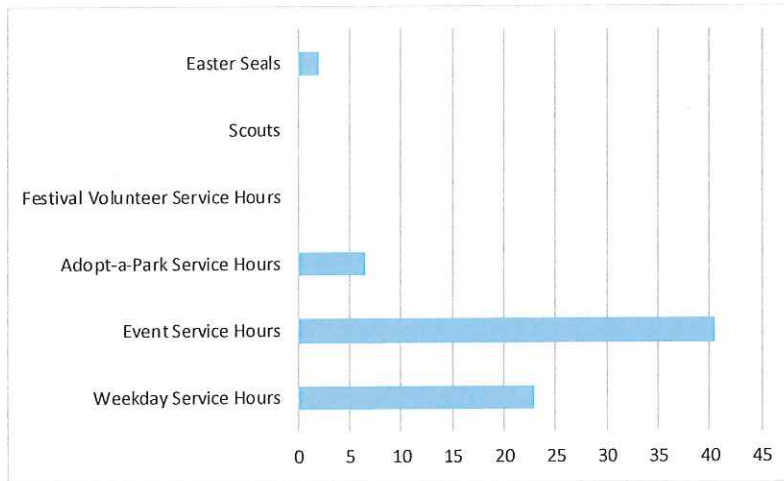

### Upcoming Events

In compliance with St. Louis County Stay in Place Order, volunteer activities have been suspended until May 18.



**231**  
Year to Date  
Service Hours



**17**  
Episodic  
Volunteers



**13**  
Weekday  
Volunteers



**2**  
Monthly  
Events

## Highlights

KHS Girl's JV/Freshman Soccer team assisted with litter clean up in Quarry Park and the surrounding neighborhoods.

Due to COVID-19 pandemic, many volunteer groups canceled participation. Additionally, the volunteer program suspended volunteer activities to comply with St. Louis County's stay in place orders.

## Other Notes

Volunteer activities will resume when safe to do so. The event calendar will be adjusted to match current needs.



City of Kirkwood Parks Recreation Department  
 Monthly Park Ranger Activity Report



Services	Jan	Feb	March	April	May	June	July	August	Sept	Oct	Nov	Dec	YTD
Park Enf. Contacts	26	38	56	32	0	0	0	0	0	0	0	0	152
Public Contacts	198	166	197	142	0	0	0	0	0	0	0	0	703
PD/FD Assist	2	2	4	1	0	0	0	0	0	0	0	0	9
PD Dispatched Calls	1	3	1	1	0	0	0	0	0	0	0	0	6
Interpretive	1	0	0	17	0	0	0	0	0	0	0	0	18
Reported Maint.	4	2	2	6	0	0	0	0	0	0	0	0	14
Injuries	0	0	0	0	0	0	0	0	0	0	0	0	0
Wildlife Related	0	0	0	1	0	0	0	0	0	0	0	0	1
Recovered Property	0	0	0	2	0	0	0	0	0	0	0	0	2
First Aid	0	0	0	0	0	0	0	0	0	0	0	0	0
Missing Persons	0	0	0	1	0	0	0	0	0	0	0	0	1

## Summary of Activities

April was a very unusual month for the parks, it seemed once St Louis County announced their closure, our park use dropped considerably for several days. Slowly people seemed to realize our parks were open for business and park use normalized for the rest of the month.

Prepared by: Senior Ranger Ronald Hall